

# ALKORPLAN

## BY ALUMASC FLEECE BACKED MEMBRANE



**ALUMASC**  
ROOFING

Solutions for adhered applications comprising of a multi-layered thermoplastic 1.5mm PVC-P roofing membrane reinforced with a glass fleece, ancillary components, insulation boards and air and vapour control layers (AVCL). Alkorplan has a proven track record of almost 45 years and is subject to the highest levels of certification and testing. Adhered using a compatible cold applied adhesive the system is fully adaptable to meet the individual requirements of every project for use across all building sectors in both new-build and refurbishment roofing projects.

### ✓ Where to Specify

- New Build
- Refurbishment
- Warm roofs (all roofing insulations)
- Overlay of existing waterproofing systems
- Compatible with all conventional roofing substrates

### ✓ Durability

BBA Certified - When installed on stable substrates and regularly maintained, the system will have a life in excess of 40 years.

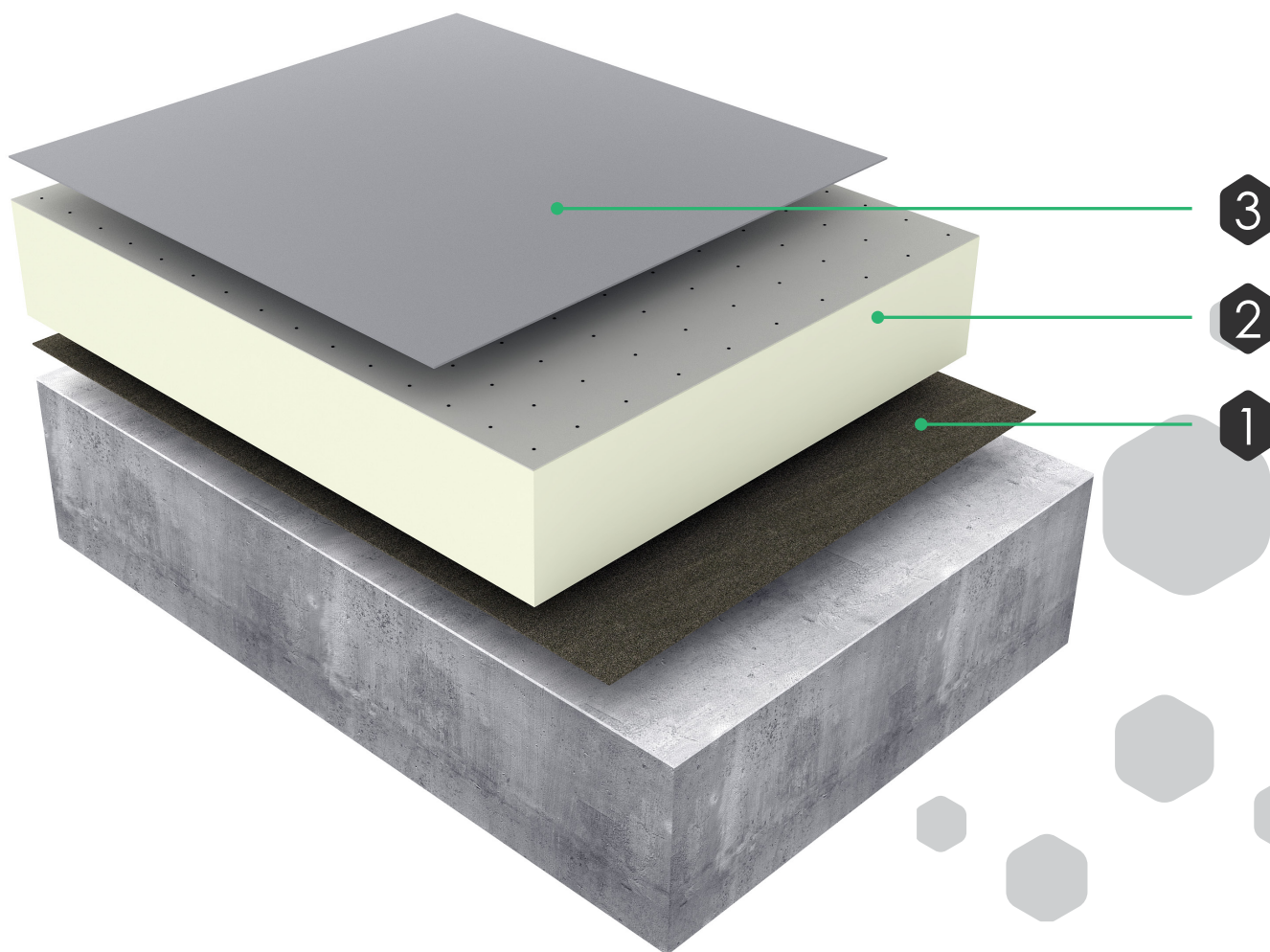

Typical Assembly	
3	Alkorplan by Alumasc Fleece Backed Membrane
	Alumasc Fleece Back Adhesive
2	PIR Insulation or Class A fire rated alternative
	PU Insulation Adhesive
1	Air & Vapour Control Layer, type according to the substrate
	Alumasc Primer, type according to AVCL

# ALKORPLAN

BY ALUMASC FLEECE BACKED MEMBRANE



**ALUMASC**  
ROOFING

## Other Common System Types

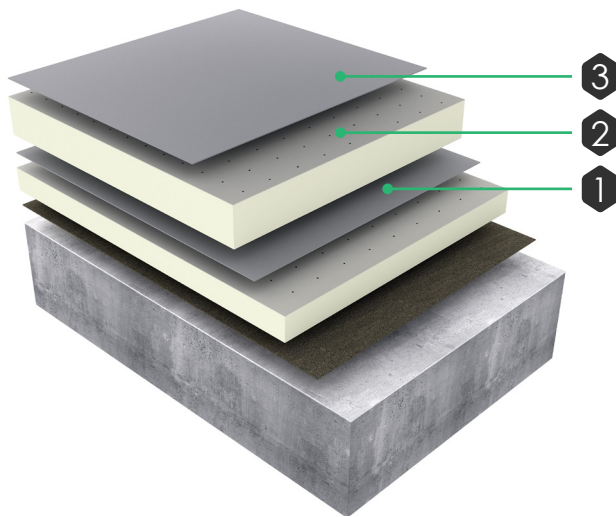

### Insulated Overlay of Existing Waterproofing

3	Alkorplan by Alumasc Fleece Backed Membrane
	Alumasc Fleece Back Adhesive
2	PIR Insulation or Class A fire rated alternative
	PU Insulation Adhesive
1	Existing waterproofing

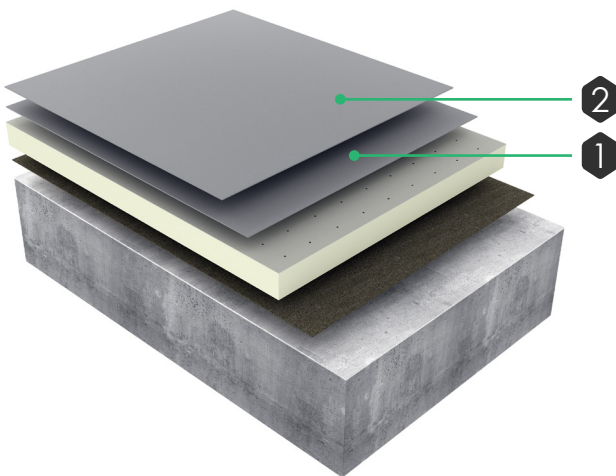

### Cold Overlay of Existing Waterproofing

2	Alkorplan by Alumasc Fleece Backed Membrane
	Alumasc Fleece Back Adhesive
	Primer, type according to the substrate
1	Existing waterproofing



### Approvals

- BBA Certificate No. 10/4808
- Fire classification of **B<sub>roof</sub> (t4)** in accordance with BS EN 13501-5



### Warranties

Alumasc offers a comprehensive range of single-source warranty options for up to 20 years. Installed exclusively by Registered Contractors and underpinned by Alumasc's extensive project support service, Alumasc warranties cover product, workmanship, and design.



### Technical Support

Alumasc Technical Services can advise on all aspects of product selection, specification and integration of Alumasc systems into any building design.



+44 (0)1744 648400



technical@alumascroofing.com



www.alumascroofing.com

Ref: SSDS-SP001 Issued:01/07/21